

FEATURES/BENEFITS

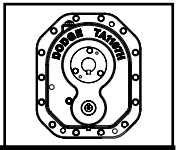

TORQUE-ARM II Shaft Mount Speed Reducers

THE LEGACY CONTINUES

MODULAR ACCESSORIES

Shaft Mounted

STANDARD TWIN TAPERED

BUSHING SYSTEM is an easy on, easy off, no-wobble bushing system featuring a fully split, ductile iron 8° taper and reliable twin support. Available in inch and metric bores.

Increased bore capability in many sizes.

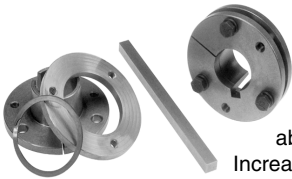

Our new **SHORT-SHAFT TWIN-TAPERED BUSHING KITS** (Patent numbers 5,667,333 and 5,951,198) eliminate the need for full-length shafts. Constructed with ductile iron,

it has all the features of our standard bushing system. Available in both inch and metric bores.



This new **MODULAR MOTOR**

MOUNT is attached and supported by two angle iron brackets with equally spaced holes, which align with the spacing of the cast slots of the gear case. This way, the motor mount can be adjusted up or down depending on the customer's requirements. It can also be mounted on the side of the reducer for screw conveyor applications.



This new **BACKSTOP** option helps prevent reverse rotation in high stop-start loads, and results in less wear and longer life. Its centrifugal throw-out design eliminates sprag sliding and reduces wear. It operates with standard and EP lubricants and requires no external lubrication.



Ruggedly constructed, the **TAROD KIT** includes standard brackets, functions as a belt-tensioning device, and offers universal mounting options.



Screw Conveyor

The new **CEMA BOLT-ON**

ADAPTER features double-lip seals on both surfaces. The adapter center is open for contaminate drop out for optimized sealing.



An optional **ADJUSTABLE PACKING KIT** bolts to the standard adapter and provides a proven sealing option for hostile environments. Packing can be retightened.



The **SCREW CONVEYOR**

DRIVE SHAFTS are made from high alloy steel and engineered to CEMA dimensions. They are three-bolt drilled and their tapered fit ensures simple installation. The rugged locking plate (patent pending) also provides a mechanical shaft removal feature.



This complete **BOLT-ON BELT**

GUARD PACKAGE requires no drilling or straps. It allows multiple height adjustments, features a hinged and lift-off cover construction, and has an open metal inspection feature.



Other accessories include cooling fans and vertical breather kits.